



PRICE GUIDE: \$450

Area: 669 m2

Low maintenance home with great neighbours

Located in a quiet street, this meticulously maintained three-bedroom home is great for families, downsizers or couples seeking a low-maintenance home.

Featuring three bedrooms, two with built-in wardrobes and air-conditioning, along with a new modern bathroom and kitchen, within an open-plan living and dining.

Step outside, and be greeted by the large open backyard and gardens, as you sit under the rear patio to enjoy the shade in the afternoon for entertaining or simply relaxing. Certainly, one of the best presented of its style on the market, and worthy of consideration by homeowners and investors alike.

THE PROPERTY

- Three bedrooms two with built-in wardrobes
- Fully air-conditioned
- Fully tiled throughout



Lynham & Co.
RENTALS



Lynham & Co. Rental

Graham Lynham
REAL ESTATE

OFFICE

37 Thuringowa Drive, Kirwan
07 4723 3222

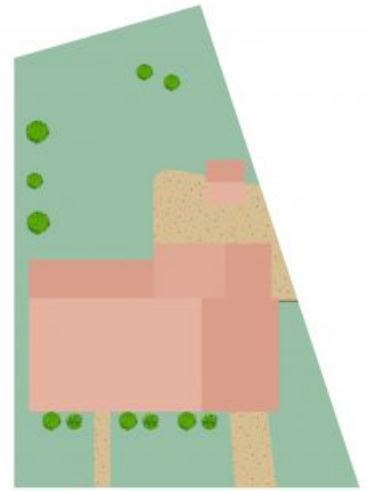
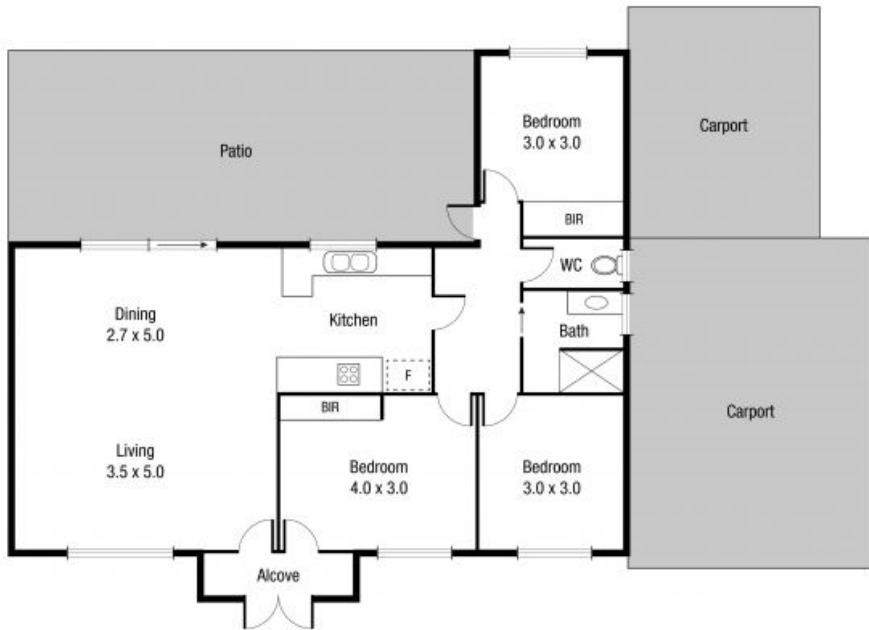

Scale in metres. Indicative only. Dimensions are approximate. All information contained herein is gathered from sources we believe to be reliable. However we cannot guarantee its accuracy and interested persons should rely on their own enquiries.

TOTAL AREA : 181.0 sq.m

10 Dollview Ave, Rasmussen