



PRICE GUIDE: Under Contract By Shelly Lynham
0414250166

Area: 640 m2

Low set family home in Mount Louisa

This low-set home is in one of Townsville's most popular suburbs. Mount Louisa, offers an affordable entry into Townsville's fast-moving real estate market.

Privately and securely positioned amongst similarly aged homes, the one-owner home since new, offers a simple but functional design, low maintenance gardens, all set on a fully fenced 640 m2 allotment.

The Property

- Open-plan living and dining area
- Functional kitchen
- Three carpeted bedrooms with built-ins
- Air conditioning in the main living area
- Two bedrooms with air conditioning
- Rear Patio
- Undercover secure car parking
- Low maintenance block 640 m2 allotment



Shelly Lynham
0414 250 166



Graham Lynham
0447 250 222



OFFICE

37Thuringowa Drive, Kirwan
07 4723 3222

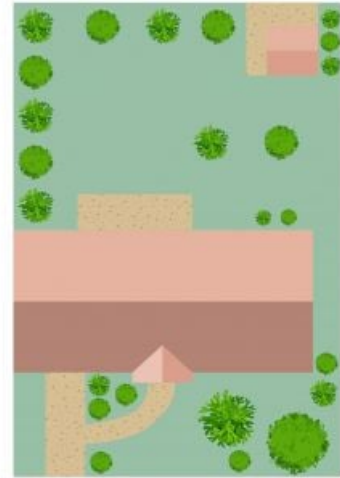
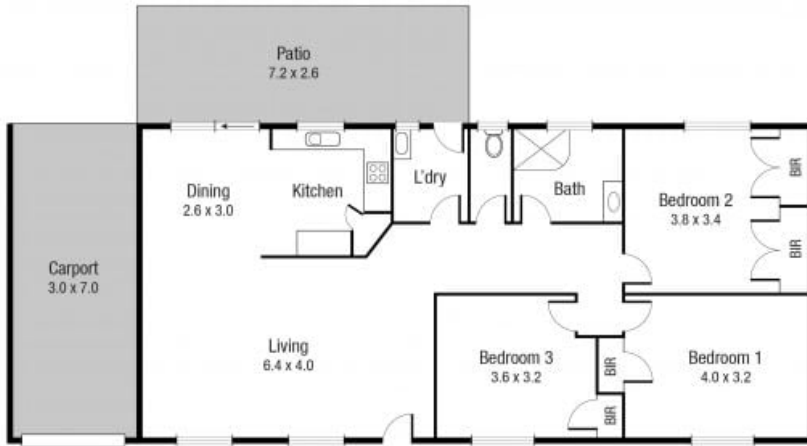

Scale in metres. Indicative only. Dimensions are approximate. All information contained herein is gathered from sources we believe to be reliable. However we cannot guarantee its accuracy and interested persons should rely on their own enquiries.



TOTAL AREA :141.92 sq.m

15 Lyndhurst St, Mount Louisa