



PRICE GUIDE: \$290,000.00

Area: 853 m2

Council Rates: \$3,737.00 p.q.

Under Contract By Nathan Lynham 0427695162

With its expansive covered outdoor area overlooking an 853 sqm block adorned with established gardens, you'll have the perfect space to host unforgettable gatherings.

This single-story gem features a low-set design with three bedrooms, all equipped with built-ins for ample storage. The property also boasts a convenient lock-up garage and garden shed, along with double gates on the side for easy access.

THE PROPERTY

- Three bedrooms with built-in wardrobes
- Galley-style kitchen with ample storage & bench space
- Open plan lounge & dining area
- Main bathroom with shower over bathtub & separate toilet
- Internal laundry with direct external access
- Large undercover patio
- Rates - \$3,737.78 per year
- Close proximity to Kelso State School and



Nathan Lynham
0427 695 162



Graham Lynham
0447 250 222



OFFICE

37Thuringowa Drive, Kirwan
07 4723 3222

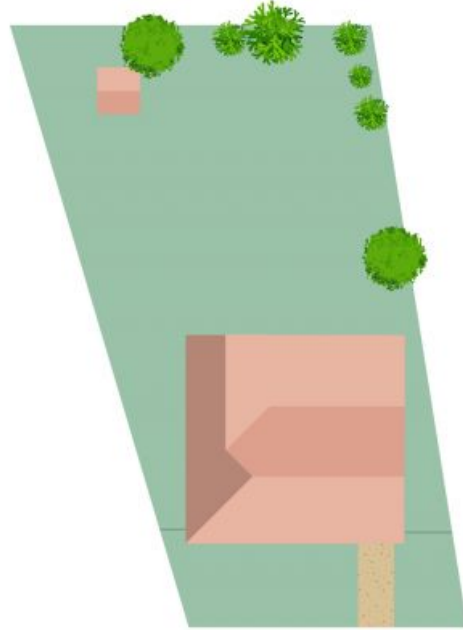

Scale in metres. Indicative only. Dimensions are approximate. All information contained herein is gathered from sources we believe to be reliable. However we cannot guarantee its accuracy and interested persons should rely on their own enquiries.

TOTAL AREA :174.42 sq.m

38 Eliza