



PRICE GUIDE: \$545,000.00

Area: 4094 m2

Council Rates: \$3,700.00 p.q.

Tranquillity, Lifestyle, Acreage, Bore

Nestled within the quiet country estate amongst similar quality homes in the much sort after Kelso Country Club Estate, sitting on a generous 4094 sq meters, this beautifully presented home represents a rare opportunity to enter the acreage market.

Presented to please, freshly painted internally, and with renovated kitchen, stone benchtops and new carpet for all four bedrooms the owners have gone to great lengths to ensure the new owner can move in and enjoy the lifestyle.

The Property

- Open plan living
- Modern kitchen with stone benchtops
- Tiled living areas
- Two separate living areas
- Study Nook
- Three bedrooms with builtins
- Large shed along with a garden shed to the



Shelly Lynham
0414 250 166



Graham Lynham
0447 250 222



OFFICE

37Thuringowa Drive, Kirwan
07 4723 3222

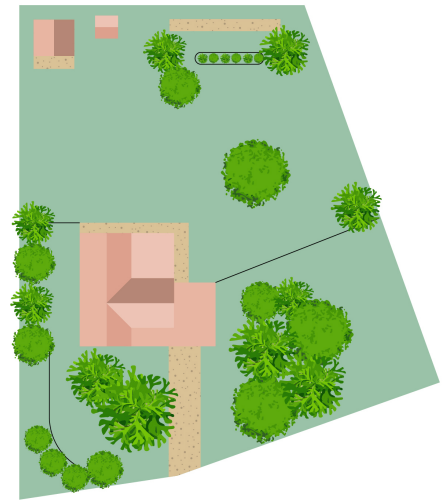
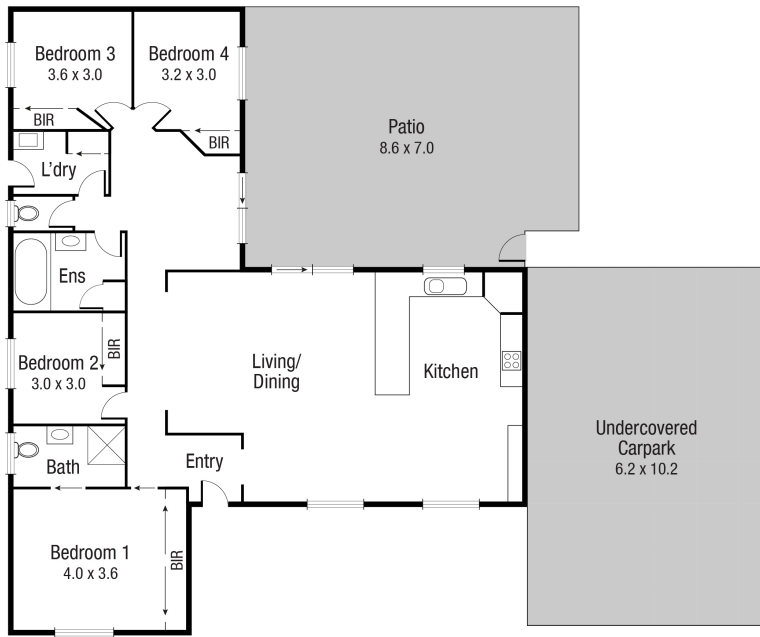

Scale in metres. Indicative only. Dimensions are approximate. All information contained herein is gathered from sources we believe to be reliable. However we cannot guarantee its accuracy and interested persons should rely on their own enquiries.

TOTAL AREA : 194.1 sq.m

33 Octagonal Cr, Kelso