



PRICE GUIDE: \$375,000.00

Area: 480 m2

Sold by Nathan and Graham Lynham 0427695162

Conveniently located in a quiet pocket of homes in Kirwan, this 4 bedroom family home needs to be seen to appreciate the fastidious efforts of the current owner in a recent full renovation to the home.

With meticulous detail, the interior of this property has been "made new" with its neutral tones and highly contemporary finish.

Tiled throughout, the home impresses from the moment you step inside.

To the front of the property are the open plan living areas including the dining and lounge.

To the left, as you enter are the first of four bedrooms with the main bedroom at the rear.

A family room compliments the design, and th



Nathan Lynham
0427 695 162



Graham Lynham
0447 250 222



OFFICE

37Thuringowa Drive, Kirwan
07 4723 3222

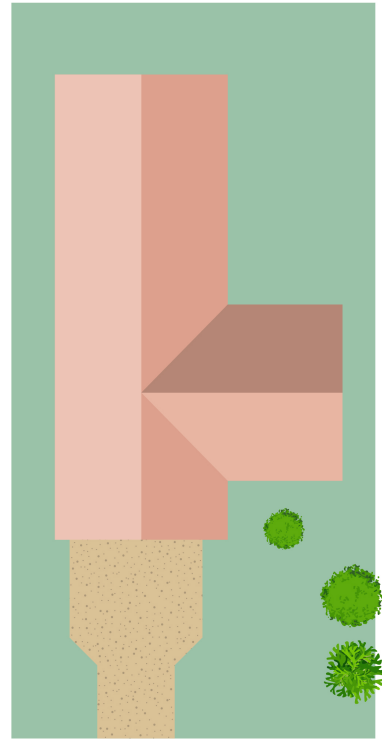
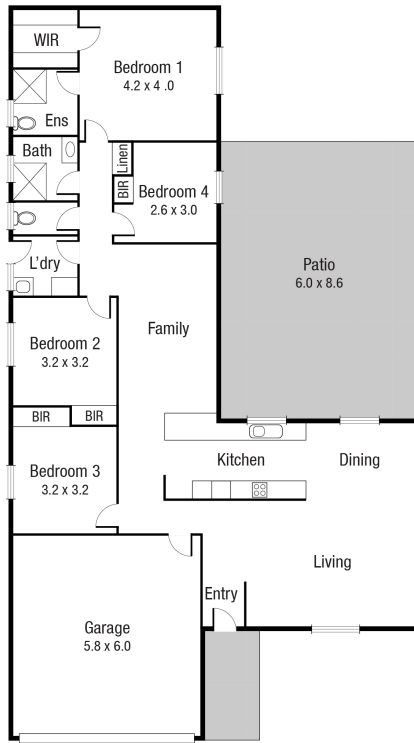

Scale in metres. Indicative only. Dimensions are approximate. All information contained herein is gathered from sources we believe to be reliable. However we cannot guarantee its accuracy and interested persons should rely on their own enquiries.

TOTAL AREA : 223.7 sq.m

19 Gilmour Cr, Kirwan