



Lynham



Lynham



Lynham



Lynham



PRICE GUIDE: \$390,000.00

Area: 703 m2

Large Family Home In Quiet Court

Located in a quiet tightly held court, amongst quality homes, this four-bedroom property has been home to the same family since built.

Generously sized, and thoughtfully positioned to allow rear access to the back yard. The home has been built with a young family in mind with the main open plan living areas to the front of the home. The large modern kitchen sits central to both the living and dining rooms and a large enclosed patio. Four bedrooms including the master with ensuite and walk-in robe complete the functional design.

The home has been freshly painted internally with new carpet, and this offers a new owner the ability to move in and make it their home.

The traditional sized 712sqm allotment offers rear yard access with room for a pool or a shed.

- Main bedroom with ensuite and walk-in robe



Shelly Lynham
0414 250 166



Graham Lynham
0447 250 222



OFFICE

37Thuringowa Drive, Kirwan
07 4723 3222

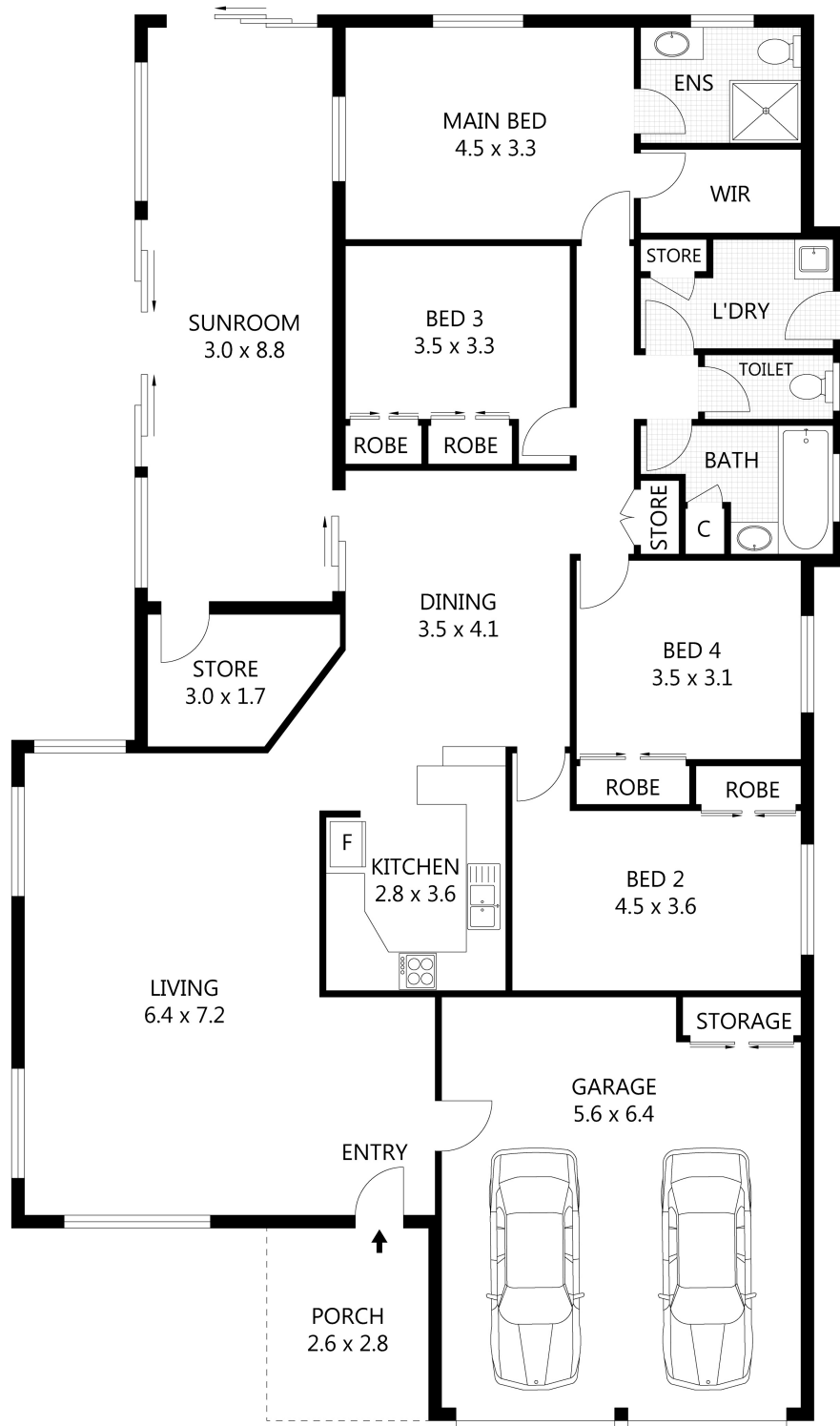

Scale in metres. Indicative only. Dimensions are approximate. All information contained herein is gathered from sources we believe to be reliable. However we cannot guarantee its accuracy and interested parties should rely on their own enquiries.

TOTAL UNDER ROOF	-	228m ²
RESIDENCE	-	185m ²
GARAGE	-	36m ²
PORCH	-	7m ²

10 Vascoe Lane, Kirwan