



PRICE GUIDE: \$395 PER WEEK

Area: 676 m2

Large 4 Bedroom Family Home In Kirwan

Located in a tightly held, well regarded area this fantastic family home should definitely be on your list of homes to inspect! It offers a highly versatile layout with enough space for a large family. With multiple living areas separated by a modern, central kitchen it is a design to maximise light and space.

THE PROPERTY

- 4 generous size bedroom with built-in wardrobes
- Large family/dining area
- Second large living area
- Modern kitchen with ample storage
- Family size main bathroom with separate shower, bathtub & toilet
- Master bedroom has private ensuite & built-in wardrobe
- Fully air conditioned
- Large patio
- No rear neighbours with Greenwood Drive Park only moments away
- 676sqm allotment
- Walking distance to New Coles complex on T



Lynham & Co.
RENTALS



Lynham & Co. Rental



OFFICE

37Thuringowa Drive, Kirwan
07 4723 3222

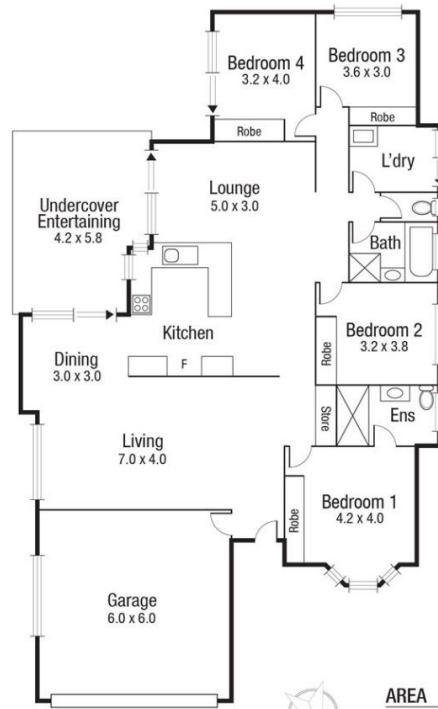
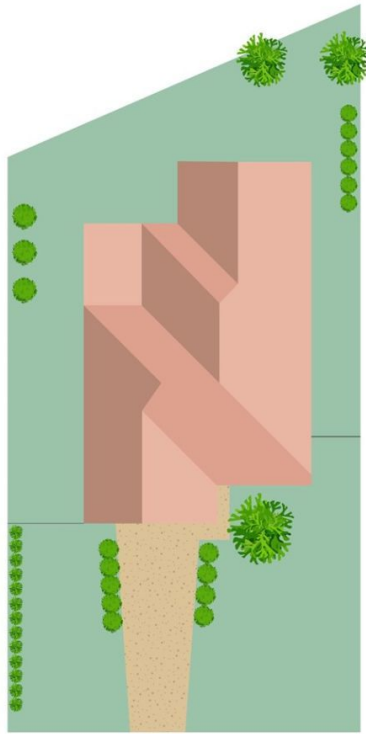

AREA	
INT	: 171.12 sq.m
EXT	: 24.36 sq.m
TOTAL	: 195.48 sq.m

Scale in metres. Indicative only. Dimensions are approximate. All information contained herein is gathered from sources we believe to be reliable. However we cannot guarantee its accuracy and interested persons should rely on their own enquiries.

19 Cavill