



**Graham  
Lynham**  
REALESTATE



**Graham  
Lynham**  
REALESTATE



**Graham  
Lynham**  
REALESTATE



**Graham  
Lynham**  
REALESTATE



Area: 2020 m2

## Stunning Executive Family Home

Rarely is a home presented to the rental market with so many inclusions. Only a few years old it is impeccably presented and built to executive quality. It has 3 living areas, a study, solar power, beautiful bathrooms and kitchen - the perfect design for families to live in harmony. **MUST BE INSPECTED TO BE APPRECIATED!**

### THE PROPERTY

- 4 Bedrooms
- Master bedroom privately located at the front of the home
- Stunning ensuite with double vanity and wrap around toilet and shower
- Custom cabinetry walk around robe
- Fully air conditioned
- Huge kitchen with stone island bench
- Massive walk in pantry
- Gas stove
- Push to open draws
- Butlers pantry
- Open plan living/dining area with cathedra



**Lynham & Co.**  
RENTALS



**Lynham & Co. Rental**

**GrahamLynham**  
REALESTATE

**OFFICE**

37Thuringowa Drive, Kirwan  
**07 4723 3222**

WIND CATEGORY C2



NOTE  
 - EXTERNAL DOORS TO BE SOLID CORE INCLUDING GARAGE DOOR.  
 - TERNITE TREATED TIMBER TO BE USED FOR ALL FRAMING AND MOULDINGS  
 - ENGINEER TO DETERMINE LOCATION OF BRACING WALLS WITH APPROPRIATE VERTICAL REINFORCEMENT

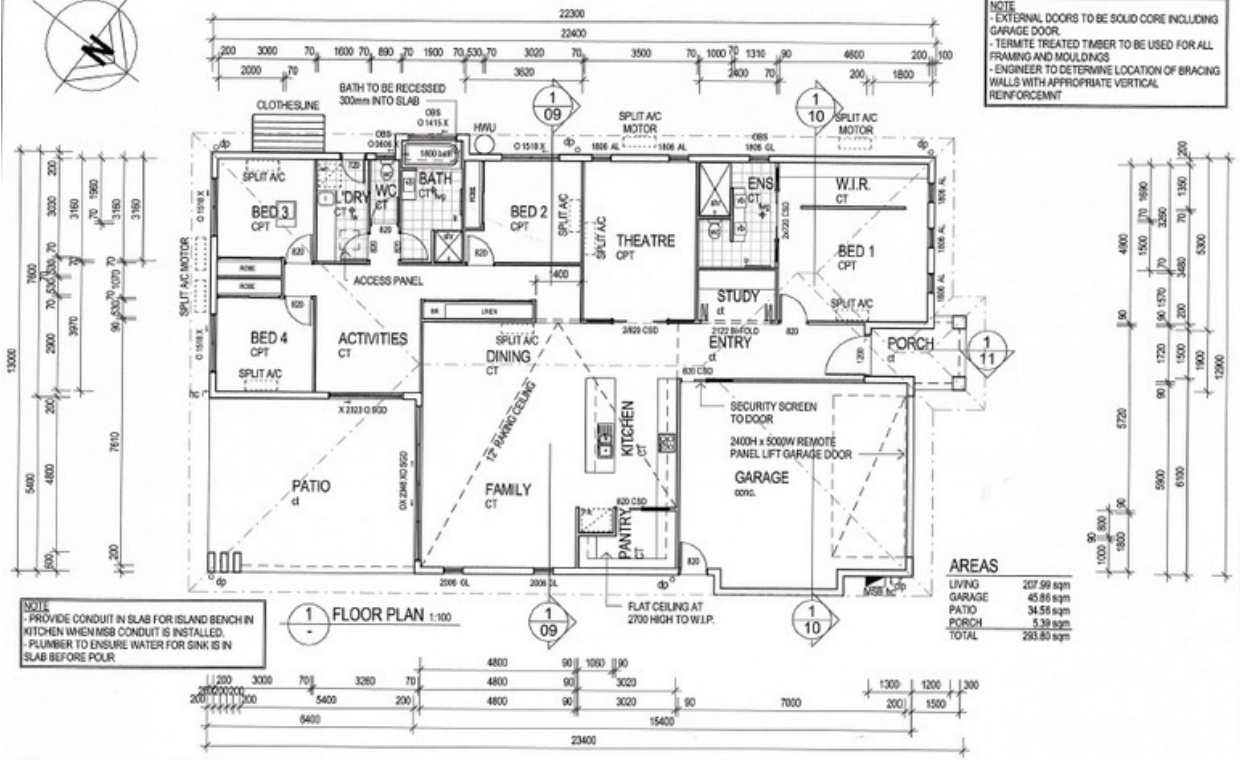

1 FLOOR PLAN 1:100

NOTE  
 - PROVIDE CONDUIT IN SLAB FOR ISLAND BENCH IN KITCHEN WHEN MSB CONDUIT IS INSTALLED.  
 - PLUMBER TO ENSURE WATER FOR SINK IS IN SLAB BEFORE POUR

AREAS

LIVING	207.99 sqm
GARAGE	45.86 sqm
PATIO	34.55 sqm
PORCH	5.38 sqm
TOTAL	293.80 sqm