



Area: 563 m2

## Sleek and modern

Effortlessly providing a relaxed lifestyle this stunning residence defines quality contemporary living. Exceptionally well proportioned this home sets itself apart from other rental properties with ease.

### THE PROPERTY

- 3 Great size bedrooms
- Master bedroom has WIR and private ensuite
- Large open plan living/dining area
- Separate media room
- Stunning modern kitchen
- Stone benchtops
- Modern stainless steel appliances
- Crim safe & security screens throughout
- Fully air conditioned
- Tiled living areas, carpeted bedrooms
- Side access to yard
- Great size entertaining area
- Walking distance to a Pirate Park for chil



**Lynham & Co.**  
RENTALS



**Lynham & Co. Rental**

**Graham Lynham**  
REALESTATE

**OFFICE**

37Thuringowa Drive, Kirwan  
**07 4723 3222**

ISS  
NTED TIMBER  
GLASS

ELEV 3

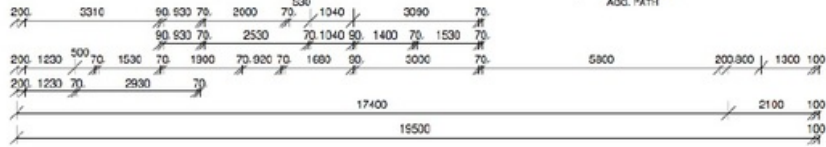
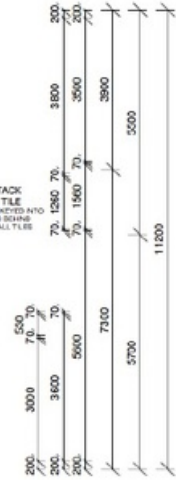
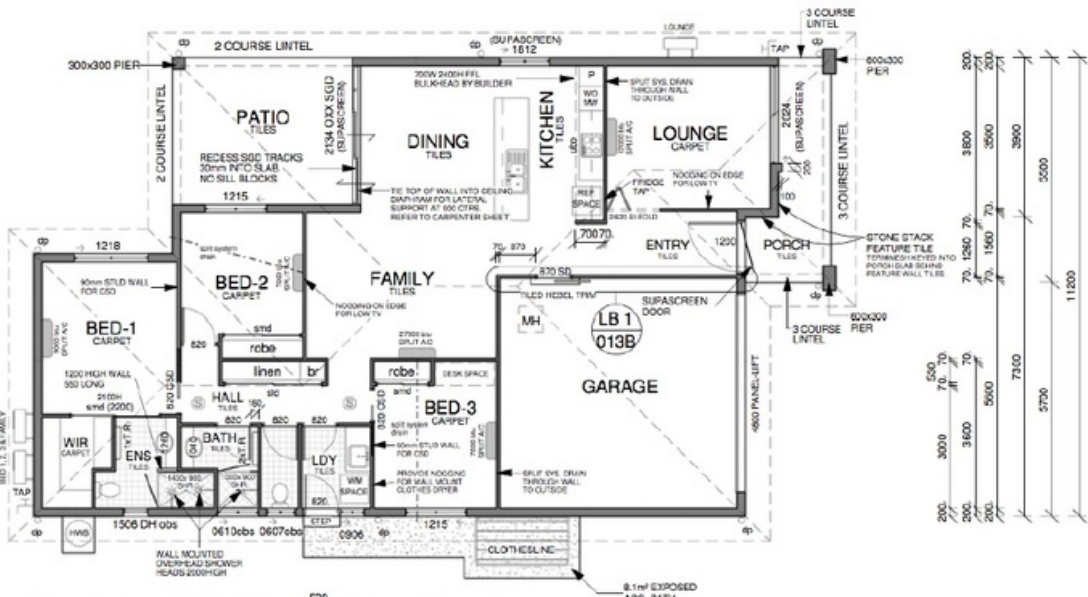
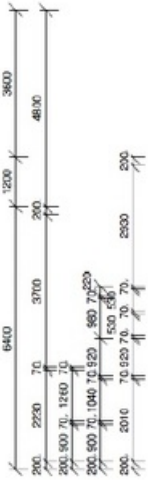
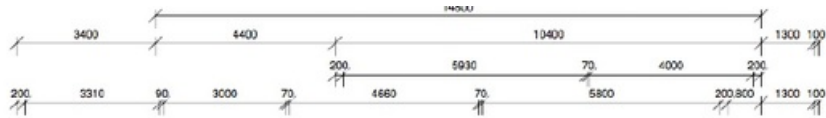

ELEV 1  
003

FLOOR SCHEDULE	
Description	Area
LIVING	131.04 m <sup>2</sup>
GARAGE	34.89 m <sup>2</sup>
PATIO	15.04 m <sup>2</sup>
PORCH	8.63 m <sup>2</sup>
	190.31 m <sup>2</sup>