



**Graham
Lynham**
REAL ESTATE



**Graham
Lynham**
REAL ESTATE



**Graham
Lynham**
REAL ESTATE



**Graham
Lynham**
REAL ESTATE



PRICE GUIDE: \$380,000.00

Area: 502 m2

Family Comfort in Ultimate Locale

This great home provides the perfect partnership of space and contemporary living. With four bedrooms and two bathrooms it is perfect for owner occupiers or those looking to invest with success.

The open plan living area has a spacious living and dining space which is overlooked by the kitchen. A large island bench, walk in pantry and stainless steel appliances are the standout features of the large kitchen.

All four bedrooms have walk in robes and the home is fully air conditioned. A private ensuite and walk in can be found in the master bedroom while the other bedrooms are serviced by the large main bathroom.

The back patio provides a great alfresco area for entertaining friends and family. All this is located on a 502sqm block.

Call today for a private inspection.



Shelly Lynham
0414 250 166

GrahamLynham
REAL ESTATE

OFFICE

37Thuringowa Drive, Kirwan
07 4723 3222

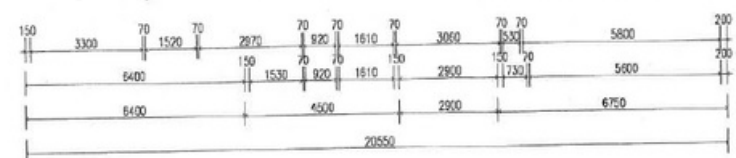
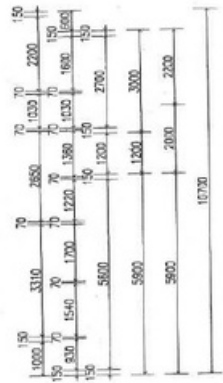
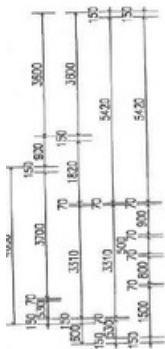
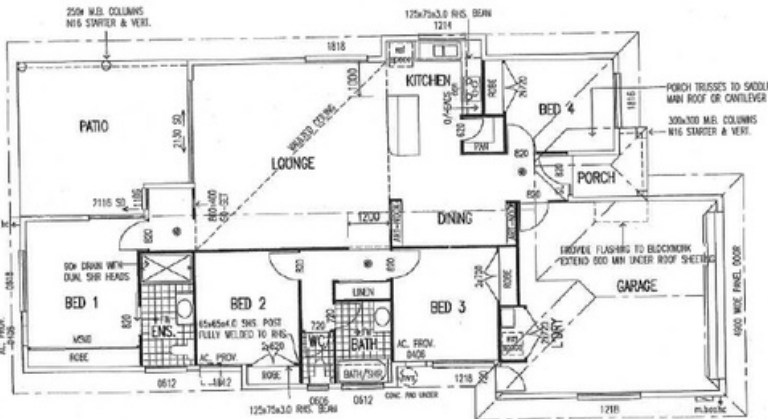
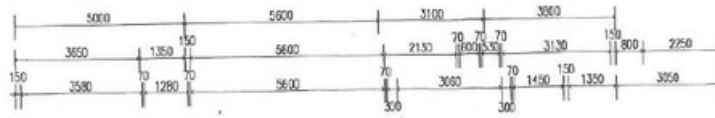

R 100/105
APPROVED
 THURINGHAM
 BUILDING CERTIFICATE

● REMOVES SMOKE DETECTORS
 WIND CATEGORY C1
FLOOR PLAN
 LIVING 125.68 Sqm
 PORCH 3.22 Sqm
 PATIO 21.28 Sqm
 GARAGE 36.52 Sqm
 TOTAL 187.10 Sqm